

Inside Corner  
Safety Rails

1.25" dia. (32 mm) or 1.50" dia. (38 mm)  
with Concealed Flanges

Architectural, Commercial, Institutional

**"Twist-Lock" Concealed Flange**

(see technical page for detail)

**SPECIFICATION: (Stainless Steel)**

Inside Corner Safety Rail with Twist-Lock concealed flanges. Manufactured by ELCOMA from 18 gauge, type 304, satin finished, stainless steel tubing. 14 gauge stainless steel mounting flange shall be Heliarc welded to the tube to form a single structural unit. Rail shall comply with all applicable federal, and local building and safety codes.

1.25" (32 mm) rail dia.  
1.50" (38 mm) rail dia.

Model # 25-223418ST  
Model # 25-523418ST

(substitute S with K for Knurled grip,  
P for Peened grip, or G for SHUR-GRIP)

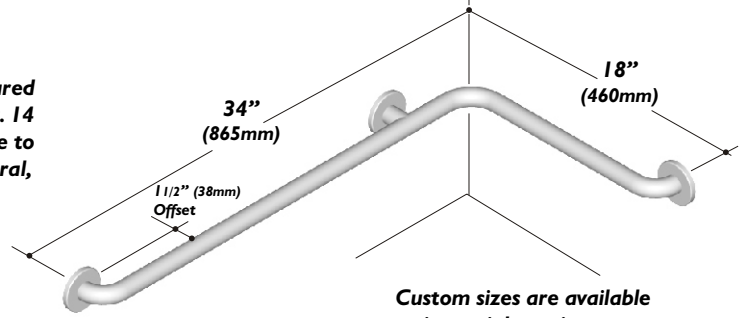

Custom sizes are available to suit special requirements.

**SPECIFICATION: (Painted Stainless Steel)**

Inside Corner Safety Rail with Twist-Lock concealed flange. Manufactured by ELCOMA from 18 gauge, Type 304, stainless steel tubing. 14 gauge stainless steel mounting flange shall be Heliarc welded to the tube to form a single structural unit. Rail shall have a polyester powder coating finish. It shall comply with all applicable federal and local building and safety codes.

1.25" (32 mm) rail dia.	White	Model # 25-263418ST01	(substitute S for smooth with G for
1.25" (32 mm) rail dia.	Almond	Model # 25-263418ST02	
1.50" (38 mm) rail dia.	White	Model # 25-563418ST01	
1.50" (38 mm) rail dia.	Almond	Model # 25-563418ST02	

**Set Screw Concealed Flange**

( see technical page for detail)

**SPECIFICATION: (Stainless Steel)**

Inside Corner Safety Rail with Set-Screw concealed flange. Manufactured by ELCOMA from 18 gauge, Type 304, satin finished, stainless steel tubing. 12 gauge stainless steel mounting flange shall be Heliarc welded to the tube to form a single structural unit. Rail shall comply with all applicable federal and local building and safety codes.

1.25" (32 mm) rail dia.  
1.50" (38 mm) rail dia.

Model # 25-223418SC  
Model # 25-523418SC

(substitute S for smooth with K for Knurled grip,  
for Peened grip, or G for SHUR-GRIP)

**SPECIFICATION: (Painted Stainless Steel)**

Inside Corner Safety Rail with Set-Screw concealed flange. Manufactured by ELCOMA from 18 gauge, type 304, stainless steel tubing. 12 gauge stainless steel mounting flange shall be Heliarc welded to the tube to form a single structural unit. Rail shall have a polyester powder coating finish. It shall comply with all applicable federal and local building and safety codes.

1.25" (32 mm) rail dia.	White	Model # 25-263418SC01	(substitute S with G for SHUR-GRIP)
1.25" (32 mm) rail dia.	Almond	Model # 25-263418SC02	
1.50" (38 mm) rail dia.	White	Model # 25-563418SC01	
1.50" (38 mm) rail dia.	Almond	Model # 25-563418SC02	

**SPECIFICATION: (Chrome)**

Inside Corner Safety Rail with Set-Screw concealed flange. Manufactured by ELCOMA from 18 gauge steel tubing. 12 gauge steel mounting flange shall be brazed to the tube to form a single structural unit prior to triple plating. Rail shall comply with all applicable federal and local building and safety codes.

1.25" (32 mm) rail dia.  
1.50" (32 mm) rail dia.

Model # 25-213418SC  
Model # 25-513418SC

(substitute S for smooth with K for Knurled grip)

For painted rails there are more than 25 designer colors available on special request.  
All bars supplied with stainless steel mounting screws

**Twist-Lock "T" Concealed Flange**

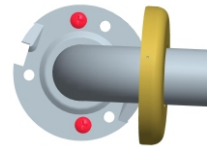

**Set-Screw "C" Concealed Flange**

